

A photograph of a sailboat on the ocean during sunset. The large, yellow sail is prominent on the left, and a person is visible on the deck in the background. The water is dark with whitecaps, and the sky is a warm orange. The text "The World Is Theirs to Explore" is centered over the image.

The World Is Theirs to Explore





In Control





Empowered



A photograph of a sailboat on the ocean during sunset. The large sail is hoisted and catches the golden light of the setting sun. A person is visible on the deck, working with the rigging. The water is dark with whitecaps, and the sky is a deep orange. The text "Many Opportunities" is centered over the image.

Many Opportunities





Many Choices





Privileged



A photograph of a sailboat on the ocean during sunset. The large, light-colored sail is partially visible on the left, and a person is seen on the deck in the background. The water is dark with whitecaps, and the sky is a warm, golden yellow. The text is overlaid in the center.

A premium condominium development  
that provides Luxurious Living in a  
World-Class Destination



# Our Development



**SAIL**  
RESIDENCES  
MALL OF ASIA, PASAY CITY



- Address: Sunrise Drive, MOA Complex, Pasay City
- Lot Area: 22,000 SQM
- Total no. of Units: 2,829
- Price Range: Php. 8 Mn – 28 Mn



# Our Development



**SAIL**  
RESIDENCES  
MALL OF ASIA, PASAY CITY

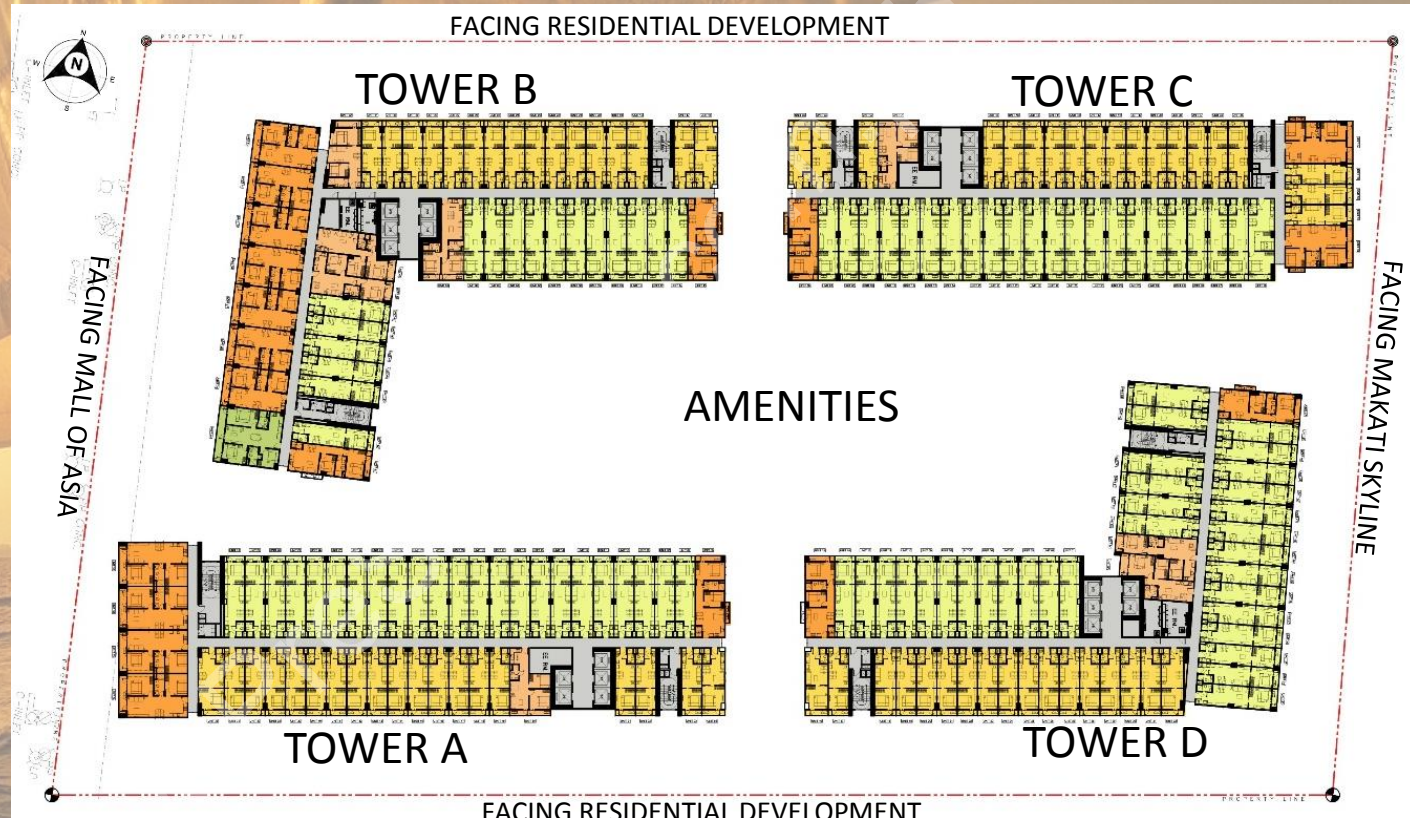

- The project is a 16 storey, 4-tower mixed used development that offers **retail/commercial spaces** at the ground floor level.
- Parking is located on the basement and ground floor.



# Our Development – Tower A



FACING MANILA BAY

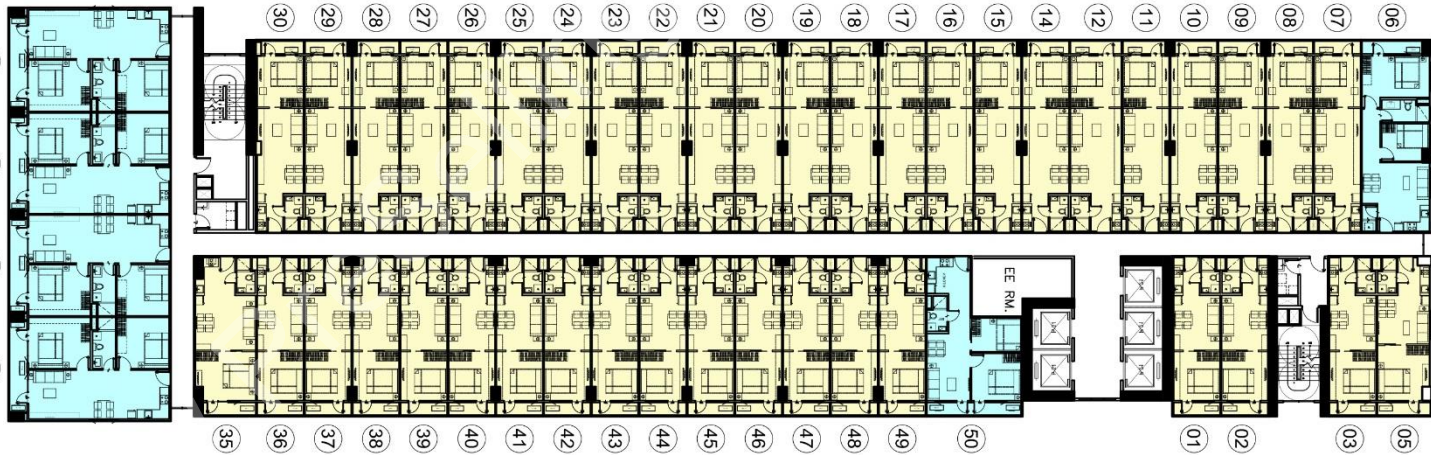

FACING AMENITY VIEW

FACING RESIDENTIAL DEVELOPMENT

**SAIL**  
RESIDENCES  
MALL OF ASIA, PASAY CITY



# Our Development – Tower B



**SAIL**  
RESIDENCES  
MALL OF ASIA, PASAY CITY

FACING MANILA BAY

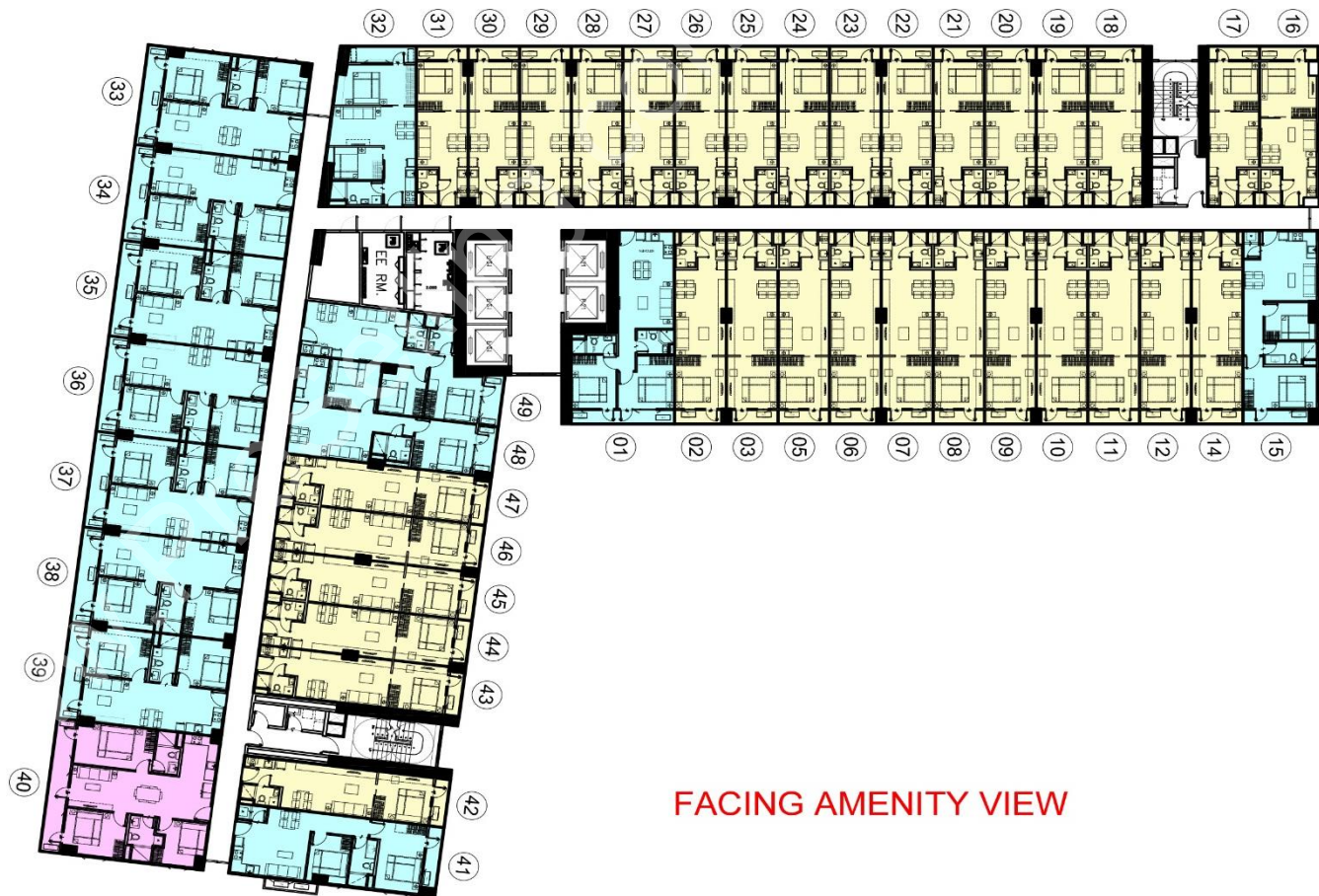

FACING RESIDENTIAL DEVELOPMENT

FACING AMENITY VIEW



# Our Development – Tower C



**SAIL**  
RESIDENCES  
MALL OF ASIA, PASAY CITY

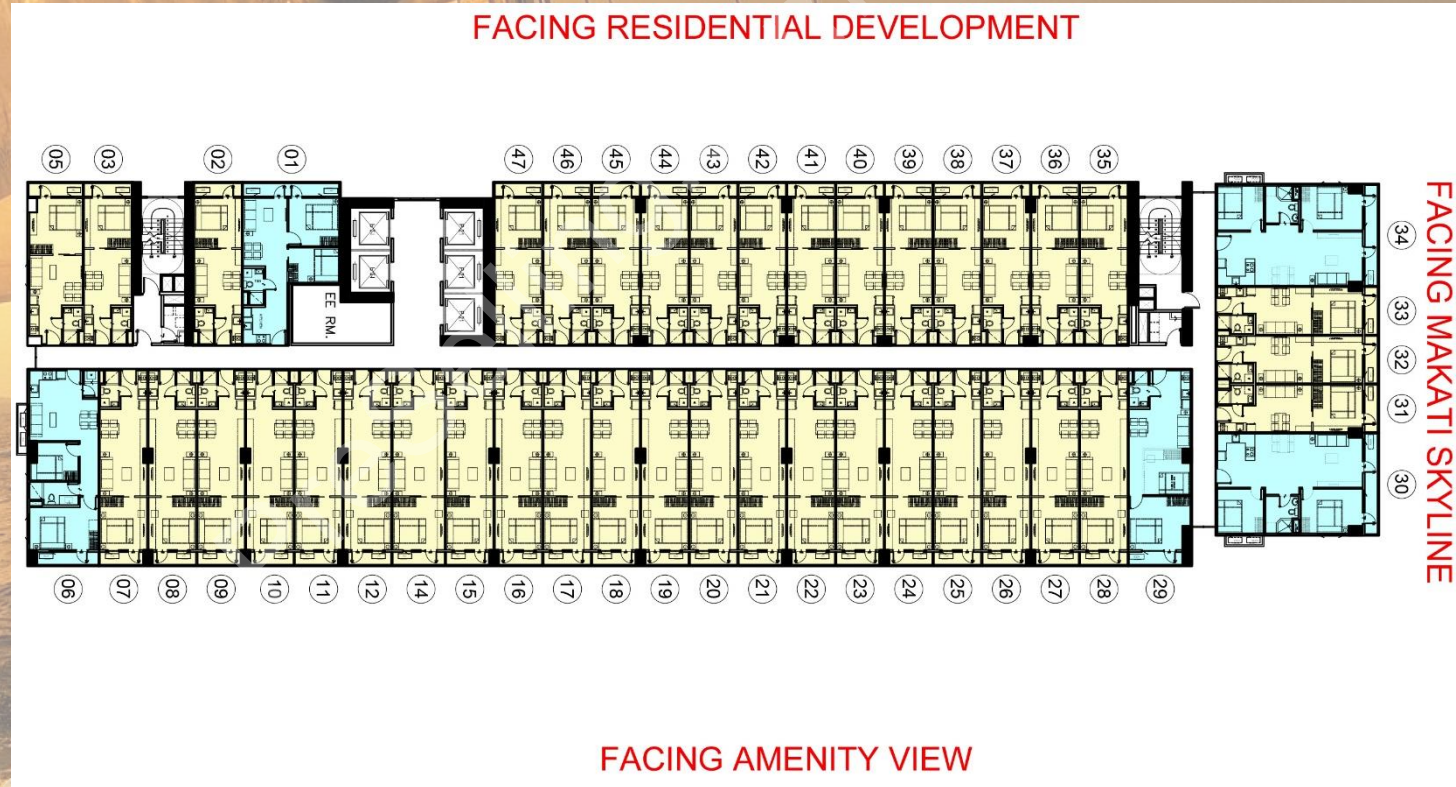



# Our Development – Tower D

FACING AMENITY VIEW



FACING MAKATI SKYLINE

FACING RESIDENTIAL DEVELOPMENT



**SAIL**  
RESIDENCES  
MALL OF ASIA, PASAY CITY



A photograph of a sailboat on the ocean during sunset. The large, yellow sail is fully deployed and dominates the upper left portion of the frame. A person is visible on the deck, silhouetted against the bright orange and yellow sky. The boat's deck, with various equipment and ropes, is visible in the foreground. The water is dark with whitecaps. A diagonal watermark "www.croSSLing.com.ph" is visible across the image.

Our Target Market



## End-Users

### Who are they:

Very successful people in their own field, earning P300-P350K net a month. Have attained a certain level of sophistication because of their corporate or entrepreneurial accomplishments coupled with their being well traveled. Married with a very young kid. Holds office in Makati or has their own business in that area. Puts a premium on the “quality” of neighborhood they belong to.

### What do we want to communicate to them:

At **Sail Residences**, you can enjoy the **Privileged Life**.

### Reasons to Believe:

In the heart of the 21<sup>st</sup>- century bayside business and entertainment district rises the pride of all SMDC premier projects in MOA. This is an exclusive premium condo development, with pristine open spaces, world class amenities and luxurious living spaces that is perfect for your discerning family.

The world is yours to explore.





# End-Users

## Who are they:

Single males, working as an executive in one of the E-com buildings, earning P250K-P300K net a month. Very successful people in their own field and have attained a certain level of sophistication because of their corporate accomplishments coupled with their being well traveled.

## What do we want to communicate to them:

At **Sail Residences**, you can enjoy the **Privileged Life**.

## Reasons to Believe:

In the heart of the 21<sup>st</sup>- century bayside business and entertainment district rises the pride of all SMDC premier projects in MOA. This is an exclusive premium condo development, with pristine open spaces, world class amenities and luxurious living spaces that is perfect for the discerning you.

The world is yours to explore.





## End-Users

### Who are they:

Single female entrepreneurs who are very successful in their business, earning P250K-P300K net a month. They have attained a certain level of sophistication because of their accomplishments coupled with their being well traveled. Quite sociable with their peers and enjoys being close to the night-life.

### What do we want to communicate to them:

At **Sail Residences**, you can enjoy the **Privileged Life**.

### Reasons to Believe:

In the heart of the 21<sup>st</sup>- century bayside business and entertainment district rises the pride of all SMDC premier projects in MOA. This is an exclusive premium condo development, with pristine open spaces, world class amenities and luxurious living spaces that is perfect for the discerning you.

The world is yours to explore.





A photograph of a sailboat on the ocean during sunset. The large, golden sail is partially visible on the left. A person is standing on the deck, silhouetted against the bright sky. The water is dark with whitecaps. The overall scene is bathed in a warm, golden light.

What kind of a lifestyle will they experience?



# Buyer Experience

Prime  
Location



Flexible  
Living  
Spaces



Buyer

Concierge  
Serviced  
Lifestyle



Country  
Club  
Amenities





# Buyer Experience

## Prime Location

Being in the center of the 21<sup>st</sup> Century Bayside District, our buyers will have a PRIVILEGED LIFE, because they will have ACCESS to WORLD-CLASS EXPERIENCES. Shop, Dine, Live, Work & Play like no other.



In the heart of the 21<sup>st</sup>- century Bayside Business and Entertainment that is both a livable and walkable community that provides...

- World-Class Dining
- World-Class Shopping
- World-Class Entertainment
- World-Class Destinations
- World-Class Working Environment



# Buyer Experience

## Flexible Living Spaces

- Well-thought out personal living spaces that allows you to explore what best suits your lifestyle.
- Bigger units, 32.16 sqm., 38.75 sqm., 61.69 sqm. and 86.07 sqm.
- Can combine units to provide lavishly luxurious spaces for your family.
- Low density per floor , giving you the privacy that you long for.



32.16 sqm- 1 BR w/ balcony



38.75 sqm- 1 BR w/ balcony



# Buyer Experience

## Flexible Living Spaces

- Well-thought out personal living spaces that allows you to explore what best suits your lifestyle.
- Bigger units, 32.16 sqm., 38.75 sqm., 61.69 sqm. and 86.07 sqm.
- Can combine units to provide lavishly luxurious spaces for your family.
- Low density per floor , giving you the privacy that you long for.



61.69 sqm- 2 BR w/ balcony



86.07 sqm- 3BR w/ balcony



# Buyer Experience



## Lobby and Lounge Area

- High-grade finishes
- Bespoke furnishings
- Sail inspired decor



# Buyer Experience

## Country Club Amenities

- Our clubhouse and gym will be in the middle of our maritime inspired pool, giving you a better view of the crystal clear waters and topiaries.
- Also our cabana like areas will be around the pool making celebrations more enjoyable.

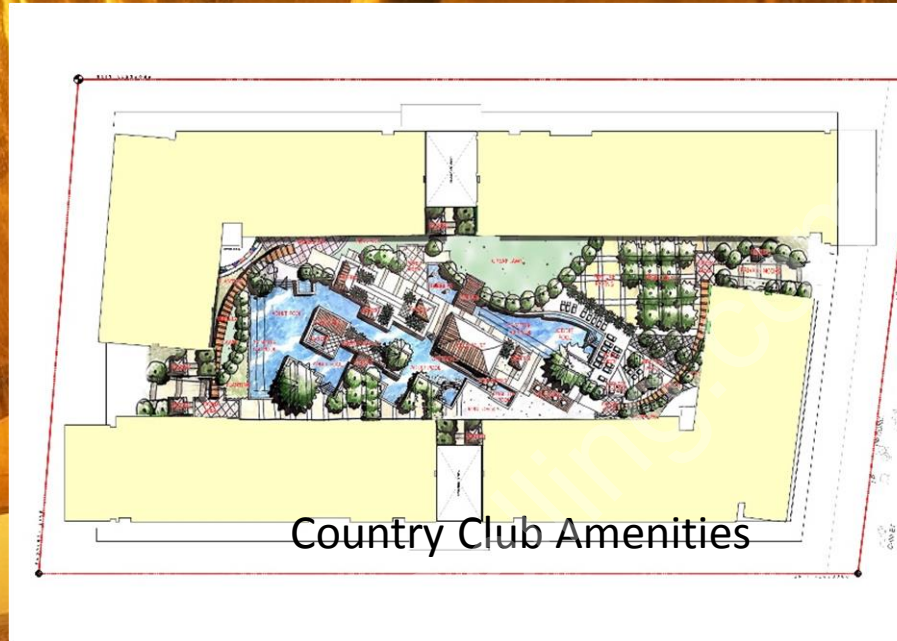

High-end Country Club amenities:

Clubhouse with luxurious lounge areas and a full gym at the second floor.

Separate cabana like areas for special functions or occasions.

Crystal clear pool

Jacuzzis

Kiddie Playground

Palm Terraces Walkways

Central Garden

Sailboat Fountain

Amenities to be enjoyed solely by you and your family.



# Buyer Experience

## Country Club Amenities

- Our clubhouse and gym will be in the middle of our maritime inspired pool, giving you a better view of the crystal clear waters and topiaries.
- Also our cabana like areas will be around the pool making celebrations more enjoyable.



Clubhouse with luxurious lounge areas and a full gym at the second floor.





# Buyer Experience

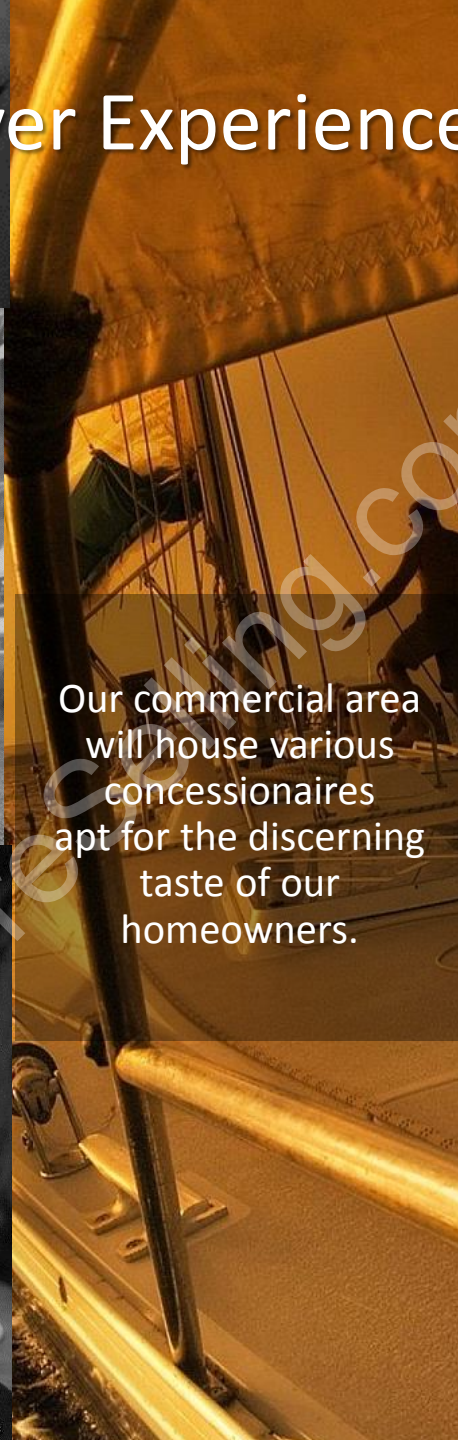

Our commercial area  
will house various  
concessionaires  
apt for the discerning  
taste of our  
homeowners.





# Buyer Experience

## Concierge Serviced Lifestyle

- Provides living experience that is convenient, comfortable and secure; elevating the lifestyle of homeowners and residents of its managed properties.
- First-class facility maintenance, management and safety.

**Professional  
Property  
Management**

**GREENMIST**  
PROPERTY MANAGEMENT CORP.

**SMDC**  
LEASING





A photograph of a sailboat on the ocean during sunset. The large, golden sail is the dominant feature on the left, catching the low sun. A person is visible on the deck in the background, silhouetted against the bright sky. The water is dark with whitecaps, and the overall scene is bathed in a warm, golden light. A watermark 'www.croisiering.com.ph' is visible diagonally across the image.

Now, the World Is Yours to Explore



A photograph of a sailboat on the ocean during sunset. The large sail is hoisted and catches the golden light of the setting sun. A person is visible on the deck in the background. The water is dark with whitecaps. The overall scene is bathed in a warm, golden glow.

[www.PreSelling.com.ph](http://www.PreSelling.com.ph)  
[info@preselling.com.ph](mailto:info@preselling.com.ph)  
+63 917 703 7707